

USER MANUAL

T4 - E

V1

October 2024

TABLE OF CONTENTS

THANK YOU FOR PURCHASING AN INNLED PRODUCT

*« Dedicated to supporting a French industrial ecosystem, this product was developed and assembled by our team in our Montpellier workshop.
Because we attach special importance to the feedback of our customers, we invite you to contact us for any comment or suggestion.
In order for us to continue to enlighten your ideas in the best possible way...»*

INNLED Team

1	2	3	4
PRECAUTIONS FOR USE P4	CE CONFORMITY CERTIFICATE P7	INTRODUCTION AND OVERVIEW P8	CASE CONTENT & ASSEMBLY P12
	5	6	7
	REMOTE CONTROLLING P19	BATTERY P25	MAINTENANCE & CLEANING P28

PRECAUTIONS FOR USE

WARNING !

- Read the precautions in this manual before installing, switching on, using or maintaining this product.
- The following symbols are used to identify important security information of the product.

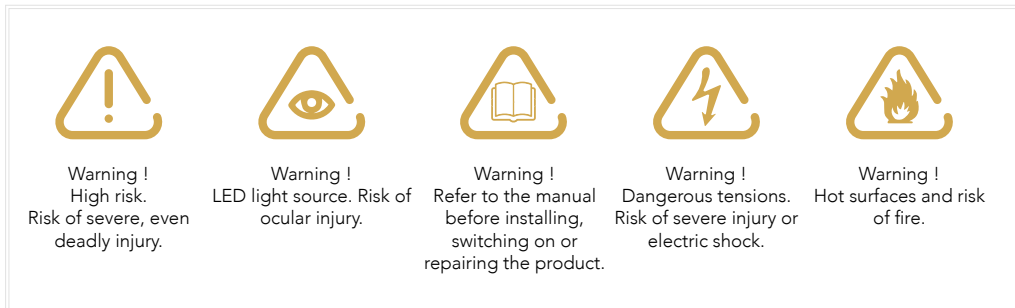

 Warning! Risk Group 1 product according to EN 62471.
Avoid directly looking into the beam source and do not observe the beam source with an optical instrument or any device that would concentrate the light.

This product is for professional use only. It is not intended for home use. It presents risks of serious injury by burns, fire, electric shock and fall from heights if the precautions for use are not followed.

Do not install, use, or service this product unless scrupulously following the instructions given in this manual, you could otherwise be creating a security risk and damage that would not be covered by the warranty.

 Follow the warnings listed below and respect all warnings printed in this manual. Keep this manual for future use.

For updates of the documentation and any information relative to this product and the rest of the INNLED range, visit our website: www.innled.fr.

For any questions about the safe handling of this product, contact your INNLED dealer or call for technical assistance from Monday to Friday from 9am to 6pm: +33 9500 508 78.

Respect all local standards and regulations during the installation, when switching the product on for the first time.



PROTECTION AGAINST ELECTRIC SHOCKS

Do not use the product in the rain, do not immerse in water.

> Turn off the device before proceeding with installation or maintenance
> Disconnect the power supply from the mains before proceeding to the installation or maintenance.

The power outlet or external power cut that powers the device must be located nearby and easily accessible in order to disconnect it from the mains. Immediately isolate the mast from the mains if the mains plug, a gasket, a cable or any other component is visibly damaged, defective, deformed, wet or seems to be overheated.

Do not power the system until all repairs have been completed. Before using the device, check that the equipment and cables are in perfect condition and certified for the electrical needs of connected devices.



PROTECTION AGAINST BURNS AND FIRES

Do not use the product if the ambient temperature (T_a) exceeds $40\text{ }^{\circ}\text{C}$ ($104\text{ }^{\circ}\text{F}$). The surface of the device can reach $65\text{ }^{\circ}\text{C}$ during use. Keep combustible and / or flammable materials away from the product. Do not stick filters, masks or any other material on the optical components. The Li-Ion battery pack should always be handled with care. In case of shock, check that there is no unwanted heating.



PROTECTION AGAINST EYE DAMAGE

Do not look directly into the light beam. Do not look into the beam with magnifying optical instruments (telescope, binocular glasses or equivalent instruments) that could concentrate the beam. Make sure that individuals can not look directly into the beam from the front of the spotlights when the product lights up suddenly.

This can occur when the power is turned on, when the system receives a DMX signal or when menu items are enabled. To minimize the risk of irritation or eye injury, disconnect the device from the mains or battery when it is no longer used and provide adequate illumination during work periods so that the eye pupils of people working nearby are naturally reduced.



PROTECTION AGAINST INJURY

The device should not be moved during use or when assembled, the modules could fall.

In case of a malfunction, immediately switch off the mast and disconnect it from the mains or battery. Do not try to repair a device that has been visibly damaged. Do not modify the unit if it is not described in this manual. Refer any service operation not described to a qualified technician.

2

CE CONFORMITY CERTIFICATE

CE DECLARATION OF CONFORMITY
DECLARATION CE DE CONFORMITE
CE KONFORMITÄTSERKLÄRUNG
DECLARACIÓN DE CONFORMIDAD CE
DI CHIARAZIONE DI CONFORMITÀ CE



We declare :

(Nous déclarons)
(Wir erklären)
(Declaramos)
(Noi dichiariamo)

Description / Type :

(Description / Type)
(Beschreibung / Typ)
(Descripción / Tipo)
(Descrizione/Tipo)

In accordance with :

(En accord avec)
(In Übereinstimmung mit)
(De acuerdo con)
(In conformità con)

Referency document :

(En conformité avec)
(Referenzdokument)
(Documento de referencia)
(Documento di riferimento)

SAS INNLED
360 avenue des compagnons
34170 CASTELNAU-LE-LEZ
FRANCE

TIMELESS LIGHTING MAST
TECNOPAR T4-E

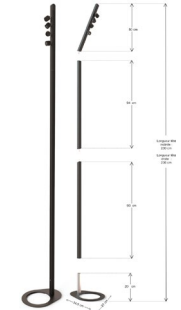

2006/95/EC The low voltage directive (**LVD**)
2004/108/EC The Electromagnetic Compatibility directive (**EMC**)
2014/53/EU Radio Equipment Directive (**RED**)

- EN55015** Limits and methods of measurement of radio disturbance characteristics of electrical lighting and similar equipment
- EN61547** Equipment for general lighting purpose. EMC immunity requirements
- EN60598-1/2** Luminaires. General requirements and test
- EN60598-2/4** Luminaires. Particular requirements - Portable general purpose lighting
- EN62031** LED module for general lighting. Safety specifications
- EN62471** Photo biological safety of lamps and lamp systems. Image projector
- EN61347-1/2/13** Lamp control gear. Particular requirements for DC or AC supplied electronic control gear for LED modules
- EN300328** Electromagnetic compatibility and Radio spectrum Matters (ERM)
- EN301489-1/17** Electromagnetic compatibility
- EN62479** Assessment of the compliance of low power electronic and electrical equipment with the basic restrictions related to human exposure to electromagnetic fields (10 MHz to 300 GHz)
- EN300220-2** Harmonised Standard for access to radio spectrum for non specific radio equipment
- EN301489-1/3** ElectroMagnetic Compatibility (EMC) standard for radio equipment and services
- EN62311** Assessment of electronic and electrical equipment related to human exposure restrictions for electromagnetic fields (0 Hz - 300 GHz)
- EN61000-3.2/3.3** Electromagnetic compatibility (EMC)

Eric GASIGLIA
SAS INNLED CEO
Castelnau-Le-Lez,
le 01/10/2024

3

INTRODUCTION & OVERVIEW

The T4-E is a battery-powered lighting mast, which includes 3 LEDs per spotlight and a choice of color temperatures :

- 3000K
- 4000K
- CCT Tunable white (3000K to 5600K)
- RGB

It is packaged by a sets of 2 or 3 - depending on the presence or not of extra extension tubes - in a case equipped with integrated 24V power supplies. You can remote control the T4-E with :



DMX transmitter TA51:
Only controllable with a
DMX console



LAKO Remote Control
Integrated transmitter



CRMX
by LumenRadio

New in
2025 !

BEFORE USING THIS PRODUCT FOR THE FIRST TIME

- 1 Carefully read the precautions on page 4 before the installation, switching on, using or maintaining of the device.
- 2 Unpack the device and make sure that no transport incident has damaged it. Never attempt to repair a damaged device.
- 3 Before starting up the mains, make sure the sector voltage and frequency correspond to the needs of the device.
- 4 Visit the Download page on our website (www.innled.fr) for the latest updates of the documentation and al technical information.

OVERVIEW T4-E // STANDARD CONFIGURATION



OVERVIEW T4-E WITH EXTENSIONS

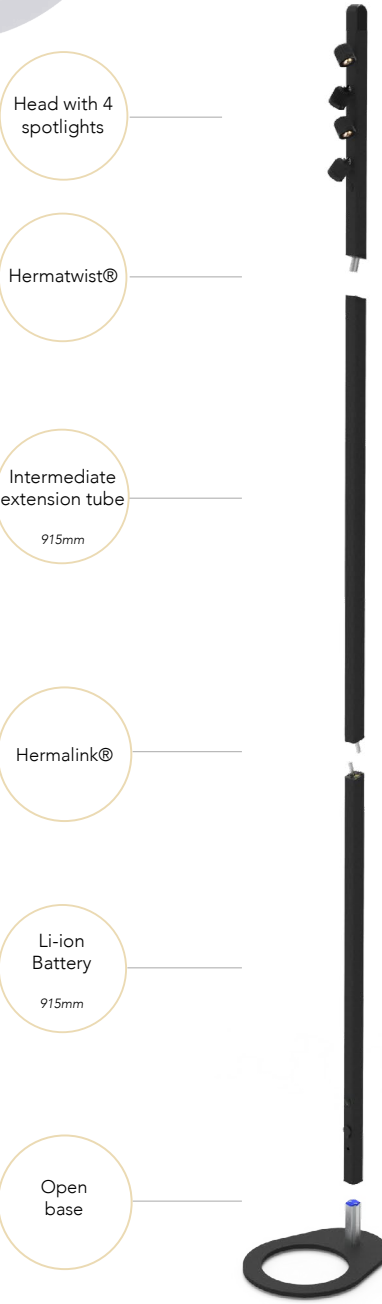

The T4-E is proposed with 2 extra extension tubes (265mm and 500mm) as well as an extra ballast.



These two additional extensions tubes allow 4 possible configurations :

INCLINED

Any other configuration, in particular > 2.80m is STRICTLY PROHIBITED

STRAIGHT

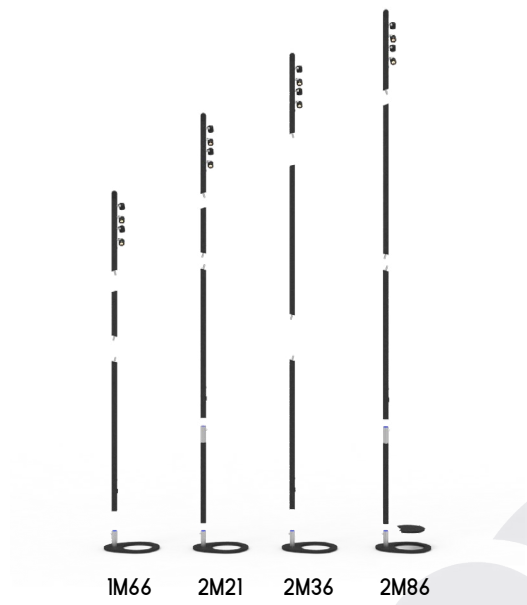
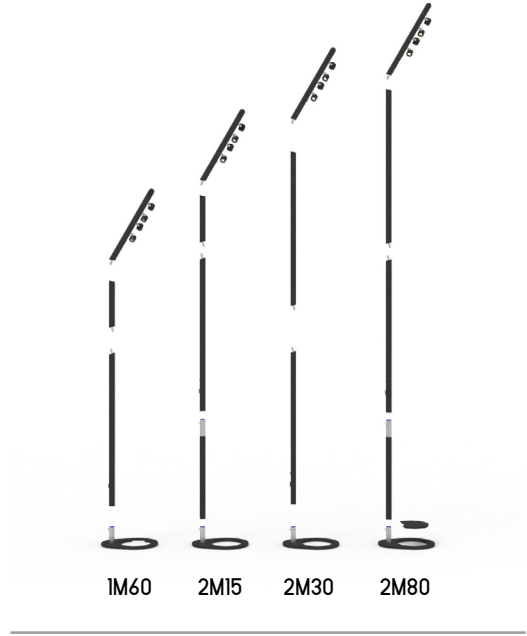

4

T4-E // CASE CONTENT AND ASSEMBLY



The transportation cases can contain either :
 > 2 x (T4-E + 500mm ext. tube + 265mm ext. tube + ballast)
OR
 > 3 x (T4-E without ext. tubes or ballast)

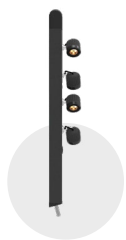

2 OR 3
HEADS WITH 4
SPOTLIGHTS



2 OR 3
BATTERY
MODULES



2 OR 3
915MM EXTENSION
TUBES

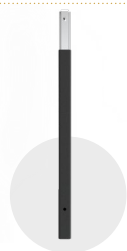

2 x 500mm
Extension tubes



2 x 265mm
Extension tubes



2 OU 3
BASES



2 OU 3
POWER SUPPLIES



2 x ballasts

Options

Options

CONTENT OF THE CASE

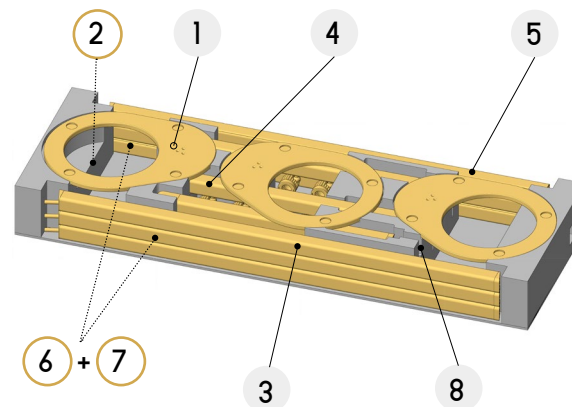

Case configuration with 3 x T4-E masts
 (without extra ext. tubes or ballasts)

- 1 BASE
- 2 BALLAST
- 3 915 MM EXT. TUBE
- 4 HEAD
- 5 BATTERY MODULE
- 6 500 MM EXT. TUBE
- 7 265 MM EXT TUBE
- 8 POWER SUPPLY 24V



The modular assembly of the T4-E offers not only a **straight or an inclined position** but also a choice of **4 possible height configurations**.

The orientation of some modules can change, depending on the configuration you desire.

Carefully read the instructions in the following pages to turn your T4-E around.



CONTENT OF THE T4-E CASE

The cases have been designed to allow the assembly of one mast after another, taking them out in a logical order facilitating the operations.

REMINDER

The transportation cases can contain either :
 > 2 x (T4-E + 500mm Ext. Tube + 265mm Ext. Tube + Ballast)
 OR
 > 3 x (T4-E = without ext. tubes or ballast)

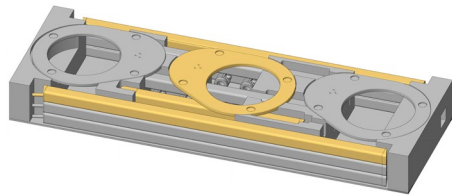

MAST N°1

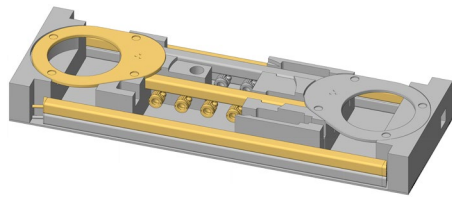

MAST N°2

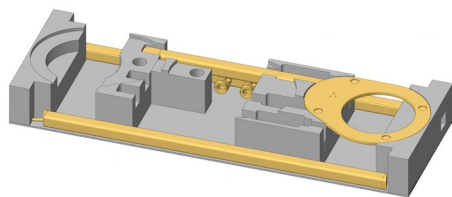

MAST N°3

2M80 ASSEMBLY (WITH OPTION OF EXT. TUBES)



Remember to turn the head module around 180° to obtain a straight mast.



Remember to turn the battery tube around 180° to obtain a straight mast.



Any other configuration, in particular > 2.80m is STRICTLY PROHIBITED



BALLAST
COMPULSORY

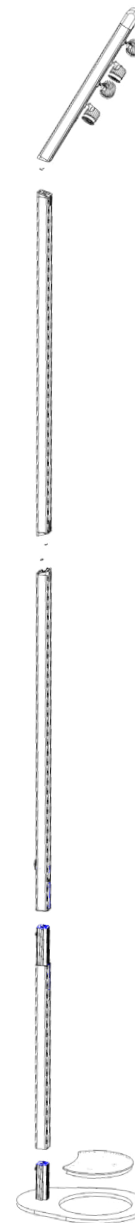

HEAD

EXT. TUBE
915MM

BATTERY
915MM

EXT. TUBE
500MM

BASE
+ BALLAST

2M30 ASSEMBLY (STANDARD CONFIGURATION)

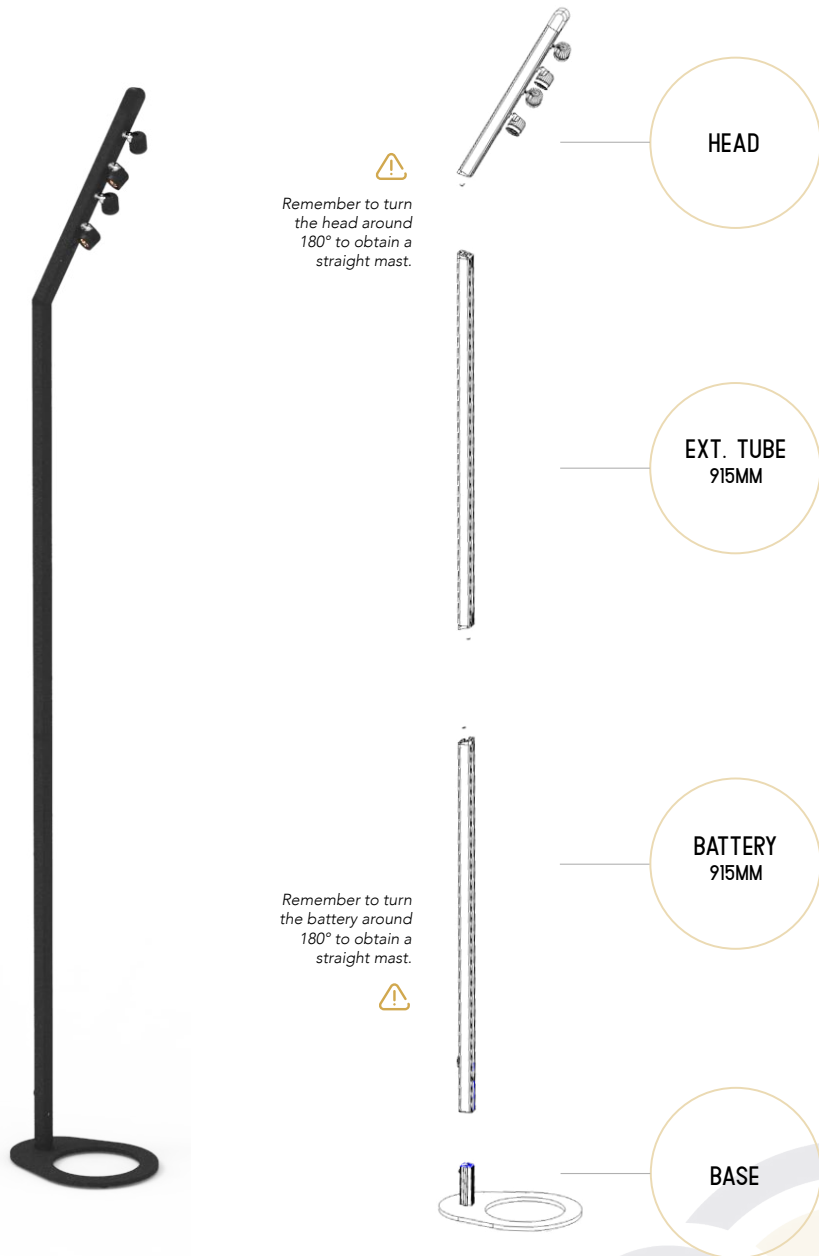

2M15 ASSEMBLY (WITH OPTION OF EXT. TUBES)

The 2.15m configuration can be assembled in spaces with low ceilings in which the 2.30m configuration does not fit.

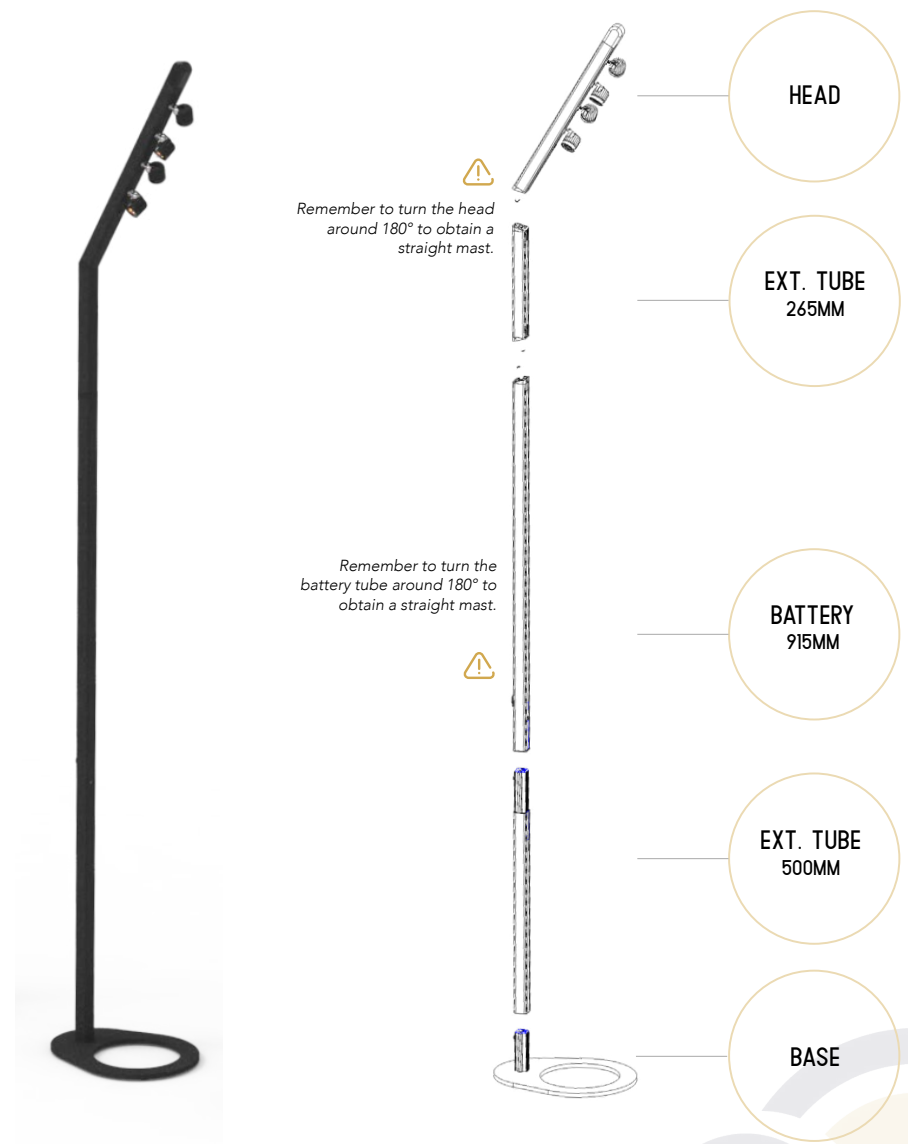

IM60 ASSEMBLY (WITH OPTION OF EXT. TUBES)

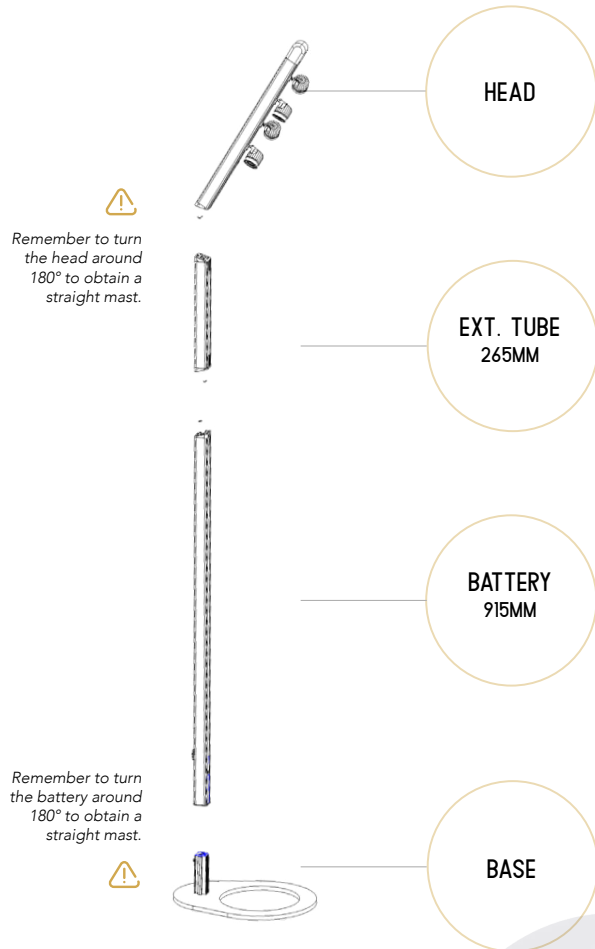

5

REMOTE CONTROLLING OVERVIEW OF T4-E HEAD



OR



**RF CONTROLLER
LUMENRADIO®**

- > compatible with :
- INNLED LAKO (TA660V)
 - INNLED Transmitter (TA51)
 - LumenRadio®'s CRMX protocole

REMOTE CONTROLLING // MANUAL MODE & USING YOUR MAST FOR THE FIRST TIME

1. Press the button briefly to **switch on your mast**, and the spotlights will start to animate : this is the LED test and rge indication of the remote controlling setting.
2. Each time you press the button, you can **vary the light intensity** (25%, 50%, 75%, 100%).
3. Press twice quickly to enter **Boost Mode**.
> 5 successive flashes indicate entry into this mode.
> Press the button again (within 30 seconds) to exit Boost Mode and return to Dimming Mode.

Caution : no action on the button for 30 seconds **locks the mast** and no further action is possible, to prevent tampering.

From this state, only a long press (press and hold) on the button turns off the mast.

Depending on the version of your head, the choice of Remote Control setting differs. Please refer to the appropriate section.



REMOTE CONTROLLING // CHOICE OF THE BASE COLOUR

CHOICE OF THE BASE COLOUR

The Base Colour is the Colour Temperature on which your mast lights up. This setting is stored in the mast even if it is switched off or without a battery.

1. When the mast is switched off, to set the base colour press and hold the button until the spotlights flash rapidly.
2. From then on, each short press on the button changes the Base Colour.
> Once the desired colour has been reached, wait for it to be saved, indicated by a series of rapid flashes.
3. The mast then enters the Remote Control setting, explained here-after.

CONTROLLING // CHOICE OF REMOTE CONTROL SETTING

CHOICE OF REMOTE CONTROL SETTING

There are 3 or 4 ways to remote control your T4-E, depending on its version.

- The **INNLED RF version** can be remote controlled :
 - a/ Manually : cf page 20
 - b/ With INNLED LAKO - TA660V
 - c/ With INNLED RF Transmitter - TA51
- The **INNLED RF + LumenRadio® version** can be remote controlled :
 - a/ Manually : cf page 20
 - b/ With INNLED LAKO - TA660V
 - c/ With INNLED RF Transmitter - TA51
 - d/ With LumenRadio® CRMX protocole



Your mast has just flashed consecutively after the selection of the Base Colour Setting.

1. From then on, each short press changes the remote control setting :
 - **flashing of the 3 LEDS** if no remote control is activated
 - **flashing as a chaser** if INNLED is activated

If you have an **INNLED + LumenRadio® RF version**, then a 3rd animation is available :

- **flashing in clockwise/anticlockwise filling mode** if LumenRadio® is activated



2. To validate the remote control mode: press and hold for 3 seconds. Memorization is indicated by 6 white flashes and restart of T4-E.

A. REMOTE CONTROLLING WITH INNLED RF

- **Remote controlling your mast with LAKO - TA660V**
LAKO allows you to control your masts remotely from a single device : the RF DMX transmitter is integrated into the remote control. Effects, colors and intensity can be customized.
> Refer to *LAKO manual*.

- **Remote controlling your mast with the transmitter - TA51**
The TA51 transmitter assigns DMX addresses to T4-4 masts via the ASSIGN menu. T4-E have 5 DMX channels, while the TA51 transmitter manages 512 DMX channels per universe.
The TA51 transmitter has 31 DMX universes and 21 frequencies
> Refer to *transmitter manual*.



LAKO
(TA660V)



CONSOLE +
RF TRANSMITTER
(TA51)

B. REMOTE CONTROLLING WITH LUMENRADIO®

1. You have just selected LumenRadio® setting in the configuration / control menu - this is indicated by a rapid flash of the LEDs.
2. A rapid fill of the spotlights takes place for 10 seconds (*), followed by another series of flashes. Your mast has selected LumenRadio® and exited the Configuration Menu.
3. To assign your mast to your LumenRadio® transmitter, please refer to the corresponding LumenRadio® manual.

(* If this is not the first time you've used your mast in LumenRadio® configuration, and you wish to unpair your mast from a LumenRadio® transmitter, press and hold the button during these 10 seconds (during the fast clockwise/anticlockwise filling). The LEDs freeze to indicate that unpairing has been done, and you can release.

6

BATTERY



- The T4-E battery module is now placed directly on the base - and will ONLY function when it is assembled on the base. T4-E offers an enhanced stability thanks to a lower gravity center of the product.
- Charge the battery module using the magnetic connector. The T4-E power supply is identified by the following logo :

BUTTON
> with LEDs for indication of the battery status

MAGNETIC CONNECTOR



LEDS AND BATTERY CHARGING STATUS

To check the T4-E battery's state of charge, press the button and the LEDs will display the battery status as shown below:

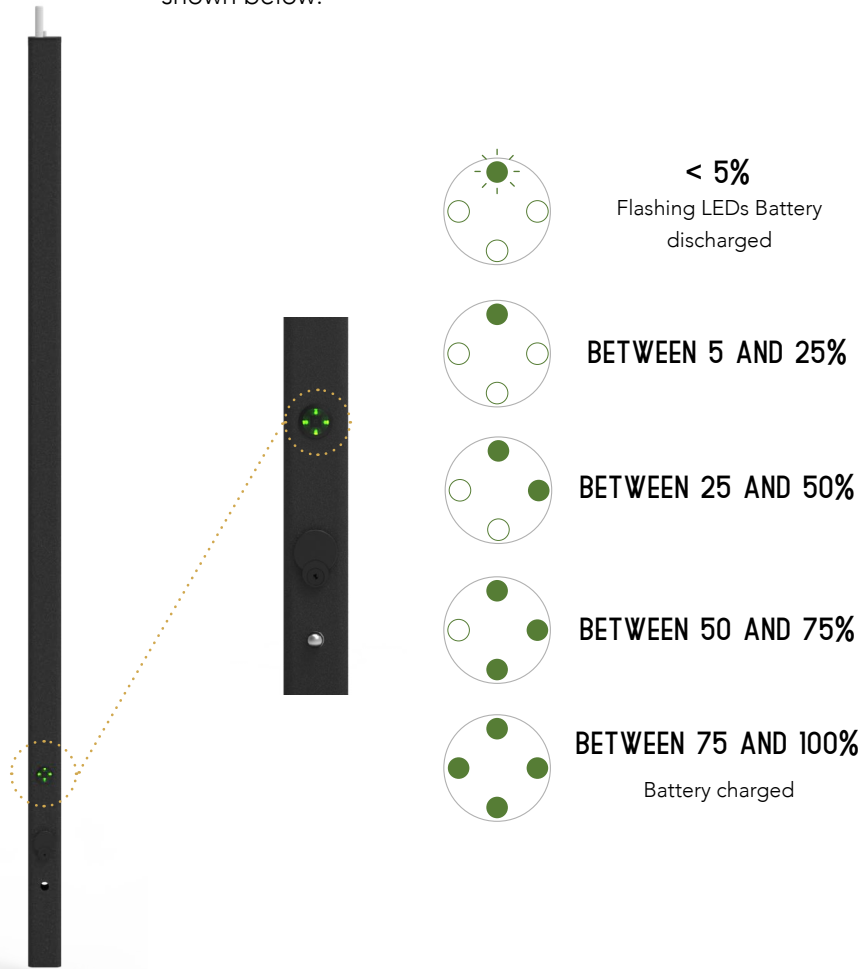

NB
In charge mode, the LEDs light up automatically. If the LEDs do not flash, the battery is charged.

PROTECTION MODE

When the battery has been subjected to a severe shock (fall, impact, etc.), Protection mode is triggered. This is indicated by rapid, alternating flashing of the LEDs. This flashing lasts for 10 minutes, making it impossible to use the battery (charge and/or discharge).

As soon as possible, isolate the battery in a safe place, away from any source of fire propagation. It is during these 10 minutes that the risk of fire is most likely to occur.

NB: At any time, if this protection mode has been triggered, a brief press on the button confirms its activation.

Indications of a faulty battery :

- overheating
- damage to the battery casing
- presence of smoke
- leakage

If any of these symptoms occur, do not attempt to reinitialize the battery and contact your distributor's after-sales service.

REINITIALIZING

You can reset the battery, but INNLED will not be held responsible for any wrong manipulation and this operation may affect warranty coverage.

1. The LEDs are off .
2. Press and hold the button for 10 seconds
3. Once the LEDs start flashing slowly, release the button and press again briefly before the LEDs stop flashing.
4. The battery has been reinitialized.

7

MAINTENANCE AND CLEANING

Read the Precautions on page 4 before servicing.

- Refer any maintenance operation not described in this manual to a qualified service technician.
- Disconnect the product from the mains before cleaning.
- Perform maintenance in an area where the risk of falling components, tools or any other material is discarded.

Excess dust, smoke and particle aggregates degrade performance and cause overheating that can damage the device. The damages caused by a hazardous cleaning or insufficient maintenance are not covered by the warranty of the product.

1. REPAIR

There are no components inside the unit which can be repaired or serviced by the user.

Do not open the different modules of the product.

Do not try to repair the device yourself, this could create a risk for safety or damage that would not be covered by the INNLED warranty. Any other intervention must be carried out by the INNLED After Sales Service.

2. CLEANING

The cleaning of the optical components must be carried out regularly to optimize the light output.

 Do not use strong pressure for cleaning

 Work in a clean and well-lit area.

 Do not use products containing solvents or abrasives, they could damage the surfaces.

To clean the device:

Check that the device is turned off.

Clean the surfaces with a microfiber cloth soaked in cleaning window solution.

Rub gently.

Clean the lenses of the LEDs softly with a clean cloth soaked in a mild detergent solution.

Do not rub the surfaces too hard. Dry with a soft and clean cloth, or low pressure compressed air. Remove any remaining particles with a wipe.

Check that the unit is completely dry before switching on.

INNLED TECHNICAL AFTER SALES SERVICE

From Monday to Friday
from 9am to 6pm

360 Avenue des Compagnons
34170 Castelnau-le-lez

+339 500 508 78
sav@innled.fr

Recycling of products



INNLED products are supplied in compliance with Directive 2002/95 / EC of European Parliament and the Council of the European Union on the Reprocessing of Electrical and Electronic Equipment (WEEE) when applicable. Help safeguard the environment by ensuring that this product will be recycled! Contact us to learn more about the local recycling provisions of our products.

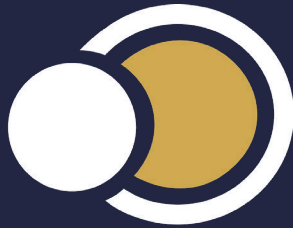

INNLED

Revealing senses

360 avenue des Compagnons
34170 Castelnau-le-Lez
FRANCE

contact@innled.fr

www.innled.fr

